

Wed, January 21 at 5:00 pm

**PRIMA VISTA BLVD AND TILTON RD
PORT ST. LUCIE, FL 34952**

HIGHLIGHTS AND FEATURES

Lot 1 is 1.72 (+/-) Acres
with 658.65' +/- of road frontage
Lot 2 is .9 (+/-) Acres
with 294.58' +/- of road frontage
Both Lots Zoned 5 units/acre
Water and Sewer Available
Includes all Concurrency Units

Terms & Conditions: Public is welcome. A \$5,000.00 cashier's check must be displayed for each property in order to bid. Properties are being sold to the highest bidder, regardless of price. A deposit in the amount of 10% of the total contract will be collected on the day of the auction with the balance due on or before February 20, 2014. TIME IS OF THE ESSENCE. 10% Buyer's premium will be applied to the top bid made and taken and will be included in the total contract price. Buyer will be responsible for all closing costs (Doc. Stamps, title insurance, etc.). Bidder information package available upon request. Property is being sold as-is, with no warranties or representations being made for use or condition. Auctioneer represents the seller in this transaction. Broker participation is available, please call to qualify. Announcements made at the auction take precedents over any printed materials.

HARTMAN AUCTION GROUP LICENSED: AB3197 AU3451
3500 SW CORPORATE PKWY, SUITE 202, PALM CITY, FL 34990



**ABSOLUTE
AUCTION**

TWO CORNER LOTS
ON PRIMA VISTA BLVD
CLOSE TO US 1
PORT SAINT LUCIE FLORIDA

ABSOLUTE AUCTION

TWO CORNER LOTS

ON PRIMA VISTA BLVD
CLOSE TO US 1
PORT SAINT LUCIE FLORIDA

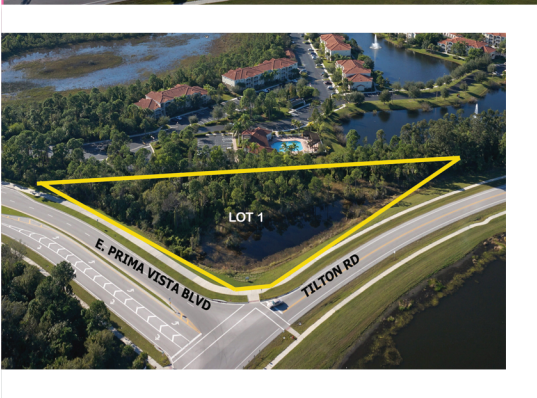

Wed, January 21 at 5:00 pm
PRIMA VISTA BLVD AND TILTON RD PORT ST. LUCIE, FL 34952

Lot 1 is 1.72 +/- Acres with 658.65 +/- feet of road frontage
Lot 2 is 0.9 +/- Acres with 294.58 +/- feet of road frontage

HIGHLIGHTS AND FEATURES

- Both Lots Zoned 5 units/acre
- Water and Sewer Available
- Located at the corner of Tilton Rd and Prima Vista Blvd in Port St. Lucie
- Includes all Concurrency Units

MORE INFORMATION AVAILABLE ONLINE



772 872 6045
WWW.HARTMANAUCTION.COM